



YUXIANG

www.magnet-tech.com

China Professional Ferrite Core Supplier

R80 DR2W 16 × 18 (S H)
 R80 DR2W 16 × 18 (S H W)

Material Type Outside Diameter(A)
 Length(D) Slot Hole Material



Type Outside Diameter(A) Length(D) Slot Hole Coil Form

Applications: Choke Coil, peaking coils

Materials can be Changed according to your request

(2)SHAPE

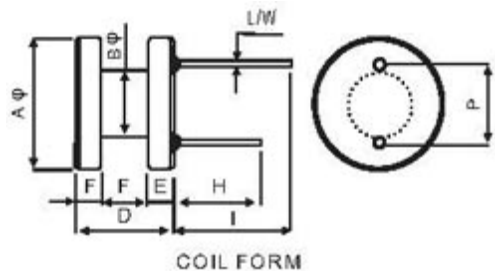
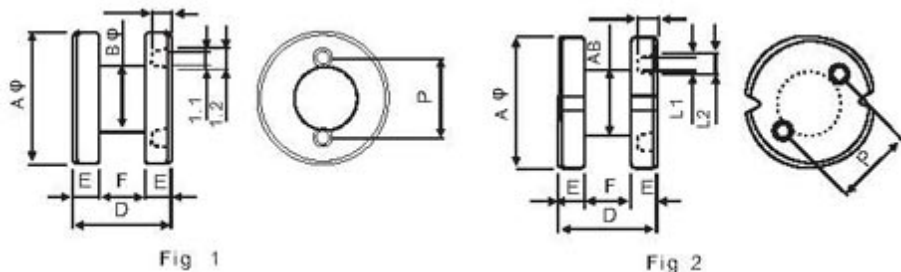

33	DR2W10×8	1	10.0 ±0.30	4.00 ±0.20	8.00 ±0.20	1.92 ±0.10	4.15 ±0.20	6	
34	DR2W10×8(H)	1	10.0 ±0.30	4.00 ±0.20	8.00 ±0.20	1.92 ±0.10	4.15 ±0.20	7	
35	DR2W10×12	1	10.0 ±0.30	4.00 ±0.20	12.0 ±0.30	2.00 ±0.10	7.00 ±0.20	5/6/7	
36	DR2W10×12(H)	1	10.0 ±0.30	4.00 ±0.20	12.0 ±0.30	2.00 ±0.10	7.00 ±0.20	5/6/7	
37	DR2W10×12(S)	2	10.0 ±0.30	4.00 ±0.20	12.0 ±0.30	2.00 ±0.10	7.00 ±0.20	5/6/7	
38	DR2W10×15(H)	1	10.0 ±0.30	5.00 ±0.20	15.0 ±0.30	2.50 ±0.10	10.0 ±0.20	6.5	
39	DR2W10×16	1	10.0 ±0.30	6.00 ±0.20	16.0 ±0.30	3.00 ±0.20	10.0 ±0.20	7.5	
40	DR2W10×16(H)	1	10.0 ±0.30	6.00 ±0.20	16.0 ±0.30	3.00 ±0.20	10.0 ±0.20	5/5.5/6	
41	DR2W10×22	1	10.0 ±0.30	6.00 ±0.20	22.0 ±0.40	4.00 ±0.20	14.0 ±0.20	6	
42	DR2W11×10(S)	2	11.0 ±0.30	4.50 ±0.20	10.0 ±0.30	2.25 ±0.15	5.50 ±0.20	5/6/7	
43	DR2W12×13(S)	2	12.0 ±0.30	6.00 ±0.20	13.0 ±0.30	2.00 ±0.10	9.00 ±0.20	7.5	
44	DR2W12×15	1	12.0 ±0.30	6.00 ±0.20	15.0 ±0.30	2.50 ±0.10	10.0 ±0.20	5/6/7	
45	DR2W12×16(H)	1	12.0 ±0.30	6.00 ±0.20	16.0 ±0.30	3.00 ±0.20	10.0 ±0.20	7.5	
46	DR2W12.5×13.5(S)	2	12.5 ±0.30	6.50 ±0.20	13.5 ±0.30	3.00 ±0.20	7.50 ±0.20	7.5	
47	DR2W13×15	1	13.0 ±0.30	6.50 ±0.20	15.0 ±0.30	3.00 ±0.20	9.00 ±0.20	7.5	
48	DR2W14×15	1	14.0 ±0.30	7.00 ±0.20	15.0 ±0.30	3.00 ±0.20	9.00 ±0.20	7.5/8/10	
49	DR2W14×15(S)	2	14.0 ±0.30	7.00 ±0.20	15.0 ±0.30	3.00 ±0.20	9.00 ±0.20	8/10	
50	DR2W15×15(S)	2	15.0 ±0.30	8.00 ±0.20	15.0 ±0.30	3.00 ±0.20	9.00 ±0.20	9.5	
51	DR2W15×18	1	15.0 ±0.30	8.00 ±0.20	18.0 ±0.30	2.50 ±0.20	13.0 ±0.20	10	
52	DR2W16×18	1	16.0 ±0.30	10.0 ±0.20	18.0 ±0.30	2.50 ±0.20	13.0 ±0.20	7.5/9/9.5/10	
53	DR2W16×18(H)	1	16.0 ±0.30	10.0 ±0.20	18.0 ±0.30	2.50 ±0.20	13.0 ±0.20	9.5/10	
54	DR2W16×18(S)	2	16.0 ±0.30	10.0 ±0.20	18.0 ±0.30	2.50 ±0.20	13.0 ±0.20	7/7.5/10	
55	DR2W16×18(SH)	1	16.0 ±0.30	10.0 ±0.20	18.0 ±0.30	2.50 ±0.20	13.0 ±0.20	9.5/10	
56	DR2W16×22	1	16.0 ±0.30	10.0 ±0.20	22.0 ±0.40	4.00 ±0.20	14.0 ±0.20	7.5	
57	DR2W16×22(H)	1	16.0 ±0.30	10.0 ±0.20	22.0 ±0.40	4.00 ±0.20	14.0 ±0.20	10	
58	DR2W18×18	1	18.0 ±0.30	10.0 ±0.20	18.0 ±0.30	2.50 ±0.20	13.0 ±0.20	9.5/12.5/13.5	
59	DR2W18×18(S)	2	18.0 ±0.30	10.0 ±0.20	18.0 ±0.30	2.50 ±0.20	13.0 ±0.20	12.5	
60	DR2W18×20	1	18.0 ±0.30	10.0 ±0.20	20.0 ±0.40	3.00 ±0.20	14.0 ±0.20	7.5/10	
61	DR2W18×22	1	18.0 ±0.30	10.0 ±0.20	22.0 ±0.40	4.00 ±0.20	14.0 ±0.20	10	
62	DR2W18×22(H)	1	18.0 ±0.30	10.0 ±0.20	22.0 ±0.40	4.00 ±0.20	14.0 ±0.20	9.5/10	
63	DR2W20×20(S)	2	20.0 ±0.30	11.0 ±0.20	20.0 ±0.40	3.00 ±0.20	14.0 ±0.20	15	