

I TYPE IRON POWDER CORES

(1) ORDING CODE

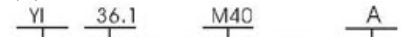

 Shape Dimension code Material Dimension difference

(2) SHAPE

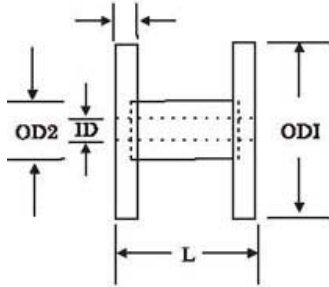

TYPE	AL	ODI	OD2	ID	T	L	W
YI36.1-40 core	85	36.10	12.70	4.37	3.96	23.80	1.84
YI36.1-40A core	60	36.10	12.70	4.37	3.96	33.30	2.95
YI46.9-40 core	100	46.90	15.90	5.56	4.75	31.80	3.43
YI46.9-40A core	80	46.90	15.90	5.56	4.75	41.30	4.90
YI63.5-40 core	130	63.50	19.10	6.60	4.75	34.90	5.66
YI63.5-40A core	95	63.50	19.10	6.60	4.75	47.60	8.49

SIZE TOLERANCE(mm)

TYPE	OD1	OD2	ID	L	T
YI36.1-YI63.5	0.00 0.25	0.00 0.10	0.10 0.00	0.35	0.35