

PLAIN TYPE IRON POWDER CORES

(1) CODING CODE

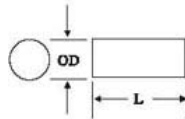

(2) SHAPE



TYPE	OD	ID	L
YP3.45-40 core	7.6	.136/3.45	.775/19.7
YP4.83-40 core	12.5	.190/4.83	.750/19.1
YP6.35-40 core	16.0	.250/6.35	.750/19.1
YP6.35-40A core	16.0	.250/6.35	1.000/25.4
YP6.48-40 core	15.0	.255/6.48	1.250/31.8
YP7.95-40 core	20.0	.313/7.95	1.000/25.4
YP7.95-40A core	20.0	.313/7.95	1.250/31.8
YP9.53-40 core	25.5	.375/9.53	1.000/25.4
YP9.53-40A core	26.5	.375/9.53	1.250/31.8
YP9.53-40B core	25.0	.375/9.53	1.500/38.1
YP9.53-40C core	22.5	.375/9.53	1.750/44.5
YP12.7-40 core	34.5	.500/12.7	1.250/31.8
YP12.7-40A core	33.0	.500/12.7	1.500/38.1
YP12.7-40B core	32.0	.500/12.7	1.750/44.5
YP12.7-40C core	31.0	.500/12.7	2.000/50.8
YP15.9-40 core	37.5	.625/15.9	1.250/31.8
YP15.9-40A core	41.5	.625/15.9	1.500/38.1
YP19.1-40 core	49.5	.750/19.1	2.375/60.3
YP25.4-40 core	80.0	1.000/25.4	2.000/50.8

Copyright 2005 YUXIANG Magnetic Materials Ind. Co.,Ltd.All Rights Reserved.

Add: 16F1 jinyuan building,NO.57,hubin S.Rd.,Xiamen,China. 361004

Tel : (86)592 2225286 (86)592 2219816 (86)592 2217138 Fax: (86)592 2207122

Email : magnetcom@gmail.com sales@magnet-tech.com